

**ALUMINCO**<sup>®</sup>  
ALUMINIUM BUILDING SYSTEMS

CANCELAS Y VALLAS







**Aluminco**, comenzó su andadura en el año 1982 con la expectativa de llegar al mercado con productos innovadores, de diseños vanguardistas y con sistemas de barandillas y escaleras creados en exclusiva, que daban a un producto tradicional como la fundición de aluminio, el prestigio e interés que necesitaba.

Actualmente, todo a evolucionado con productos de aluminio de última generación y Aluminco sigue mostrando su liderazgo y prestigio no solo por la calidad de sus productos, también por la calidad de todos sus procesos que en ella se llevan a cabo.

En nuestros días, esta desarrollando una industria del aluminio vertical, que procesa el aluminio en 3 fases:

- Extrusión: Con una capacidad de producción de 13.000 toneladas de perfil por año.
- Puertas & Paneles: Con una capacidad de producción de 70.000 paneles por año.
- Fundición: Con una capacidad de producción de 13.000 toneladas de perfil por año.

\*Aluminco ofrece una amplia gama de productos en los que destacamos:

- Perfiles de aluminio.
- Paneles de aluminio
- Puertas de entrada principal
- Sistema de barandillas y escaleras
- Farolas y muebles de jardín.

Con espíritu inquieto e innovador, continuamente se centra en la investigación y el desarrollo de nuevos productos y sistemas los cuáles cumplen completamente la calidad, estética y estándares de funcionalidad.

La calidad es un máximo referente en nuestra empresa y por ello certificamos nuestros trabajos:

- Con procesos de producción certificada por la norma ISO 9001 & ISO9014 y procesos específicos de pintura bajo el sello de calidad QUALICOAT.
- Certificados por el instituto internacional y organizaciones como: IFT Rosenheim, Bureau Veritas, TUV, INSTITUTO GIORDANO, ICC, EKANAL.

Realizamos múltiples soluciones y productos de forma personalizada, que cumplen con los requisitos de los clientes más exigentes.





# Blind V

Modern designs and countless combinations meeting the needs of modern architectural buildings. Gates made of aluminium profiles in vertical structure combined with inox elements, which renders them a true jewel placed at your house entrance.

Des motifs modernes et une multitude de combinaisons qui répondent aux besoins de bâtiments d'architectures modernes. Des portails en profilés d'aluminium d'ordre vertical, combinés avec des éléments en inox constituant ainsi un vrai bijou pour l'entrée de votre maison.



**GV02.03** Patterned vertical rabote with inox profile.  
Raboté strié vertical avec bordure en inox.



**GV01.02** Patterned vertical rabote.  
Raboté strié vertical.



**GV02.04** Patterned vertical rabote with 6mm triplex glass.  
Raboté strié vertical avec vitrage triplex de 6mm.

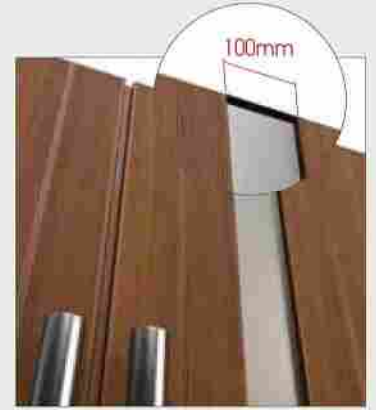

Profiles can be combined with inox profile.  
Possibilité de combinaison d'un raboté strié avec bordure en inox.



Vertical rabote can be combined with 6mm triplex glass.  
Possibilité de combinaison d'un raboté strié avec vitrage triplex de 6mm.



Sand blasted glass  
Vitrage traité par sablage

Black glass  
Vitrage noir

Suggested fences | Clôtures proposées

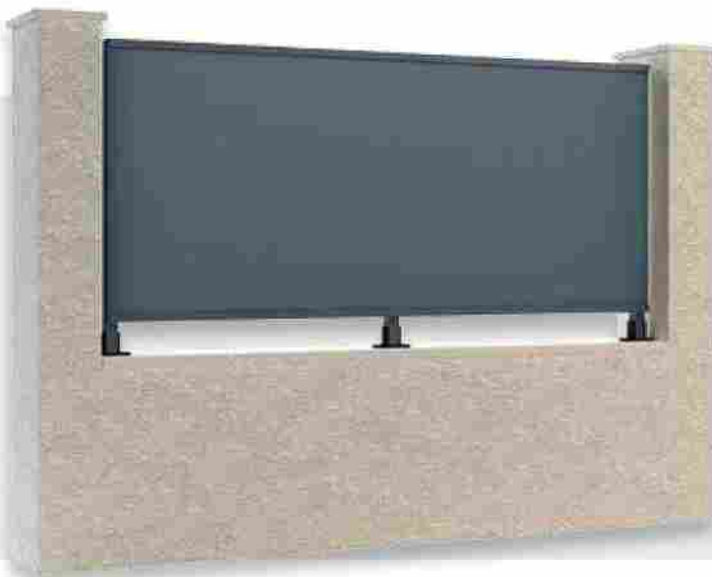

**FV10.02** Closed type fence with patterned vertical rabote.  
Clôture à raboté strié de type plein.



**FV10.70** Oval fence with vertical rabote with gaps.  
Suggested gap of 2-8cm.  
Clôture en ovale avec raboté strié dotées d'espaces. Espacement proposé de 2 à 8cm.



# Blind V



**GV02.01** Patterned vertical rabote with built-in inox elements in two levels.  
Raboté strié vertical avec des parties en inox emboîtées sur deux niveaux.



**GV01.01** Patterned vertical rabote with built-in inox elements in the same level.  
Raboté strié vertical avec des parties en inox emboîtées sur le même niveau.



**GV02.05** Patterned vertical rabote with inox profile on two levels.  
 Raboté strié vertical avec bordure en inox et parties encastrées sur deux niveaux.

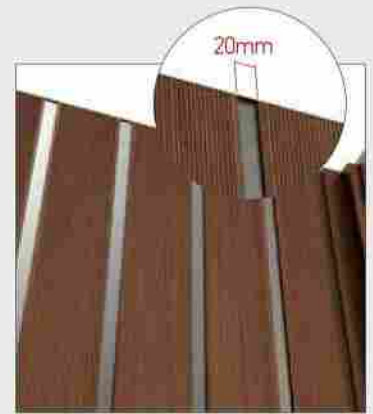

The profile can be combined with built-in inox elements (510-918) on two levels.  
 Possibilité de combiner un raboté strié avec des parties en inox (510-918) encastrées sur deux niveaux.

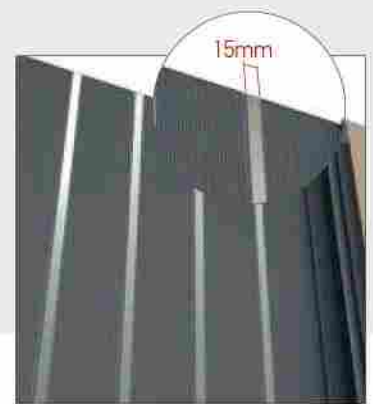

The profile can be combined with built-in inox elements (070-019) on the same level.  
 Possibilité de combiner un raboté strié avec des parties en inox (510-918) encastrées sur le même niveau.

Suggested fences | Clôtures proposées



**FV10.01** Fence with patterned vertical rabote and closed type built-in inox elements.  
 Clôture à raboté strié vertical et des parties en inox encastrées de type plein.



**FH10.70** Fence with oval horizontal rabote with gaps.  
 Suggested gap of 2-8cm.  
 Clôture en ovale avec de raboté strié horizontal dotées d'espaces. Espacement proposé de 2 à 8cm.



A variation of the main pattern made of aluminium profile in horizontal mounting. Available in a wide range of patterns and colors as well as imitation wood shades.

Une autre version du motif principal fabriqué à partir du raboté strié en ordre horizontal. Disponible en un grand nombre de motifs et de coloris tel que l'aspect bois.



**GH01.02** Patterned horizontal rabote. Raboté strié horizontal.



**GH12.01** Patterned horizontal rabote with inox sleep beading and built-in inox elements of the same color. Raboté strié horizontal avec une bordure en inox et des parties emboîtées de la même couleur.



**GH05.01** Patterned horizontal rabote with inox profile. Raboté strié horizontal avec une bordure en inox.





**GH02.03** Patterned horizontal rabote with inox profile and built-in inox elements of the same color.  
 Raboté strié horizontal avec des parties emboîtées de la même couleur.



*The profile can be combined with built-in inox rail of the same color.  
 Possibilité de combiner le raboté strié avec une partie emboîtée de la même couleur et une bordure en inox.*



*Robust hinge supporting 100kg frame.  
 Chamlière robuste de support de châssis jusqu'à 100kg.*

## Suggested fences | Clôtures proposées



**FH10.02** Closed type fence with patterned horizontal rabote.  
 Clôture à raboté strié horizontal de type plein.



**FH10.04** Fence with patterned horizontal rabote and closed type built-in inox elements.  
 Clôture à raboté strié horizontal et des parties en inox encastées de type plein.



**GH02.04** Patterned horizontal rabote with inox built-in elements.  
Raboté strié horizontal avec des parties encastrées en inox.



**GH02.05** Patterned horizontal rabote with inox built-in elements and inox slip beading.  
Raboté strié horizontal avec des parties encastrées en inox et une bordure en inox.



**GH02.06** Patterned horizontal rabote with glass.  
Raboté strié horizontal avec vitrage.



*Robust hinge supporting 100kg frame.  
Charnière robuste de support de châssis  
jusqu'à 100kg.*



*Horizontal rabote can be combined with  
6mm triplex glass.  
Possibilité de combiner un profil raboté  
strié avec un vitrage triplex de 6mm.*



*Sand blasted glass  
Vitrage traité au  
sablage*



*Black glass  
Vitrage noir*



**GH12.07** Patterned horizontal rabote with glass.  
Raboté strié horizontal avec vitrage.

### Suggested fences | Clôtures proposées

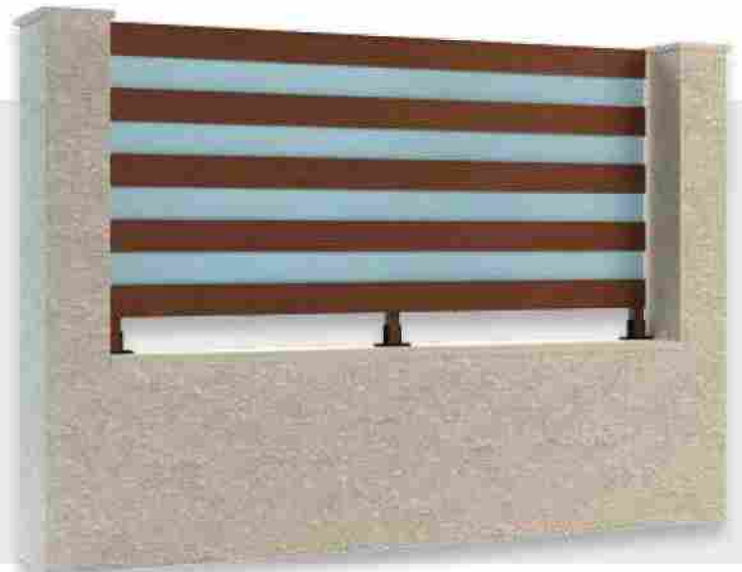

**FH10.06** Fence with patterned horizontal rabote and 6mm triplex glass.  
Clôture à raboté strié horizontal et vitrage triplex de 6mm.



# Cubic

High standard aesthetics and simple lines forming a modern construction. Aluminium profile that may be combined with various materials such as perforated aluminium sheets and polycarbonate sheets.

Une haute esthétique et des lignes simples composent un ensemble moderne. Le profilé d'aluminium, peut être combiné à des matériaux divers tels que la tôle perforée et les plaques de polycarbonates.



GC12.04



GC01.05

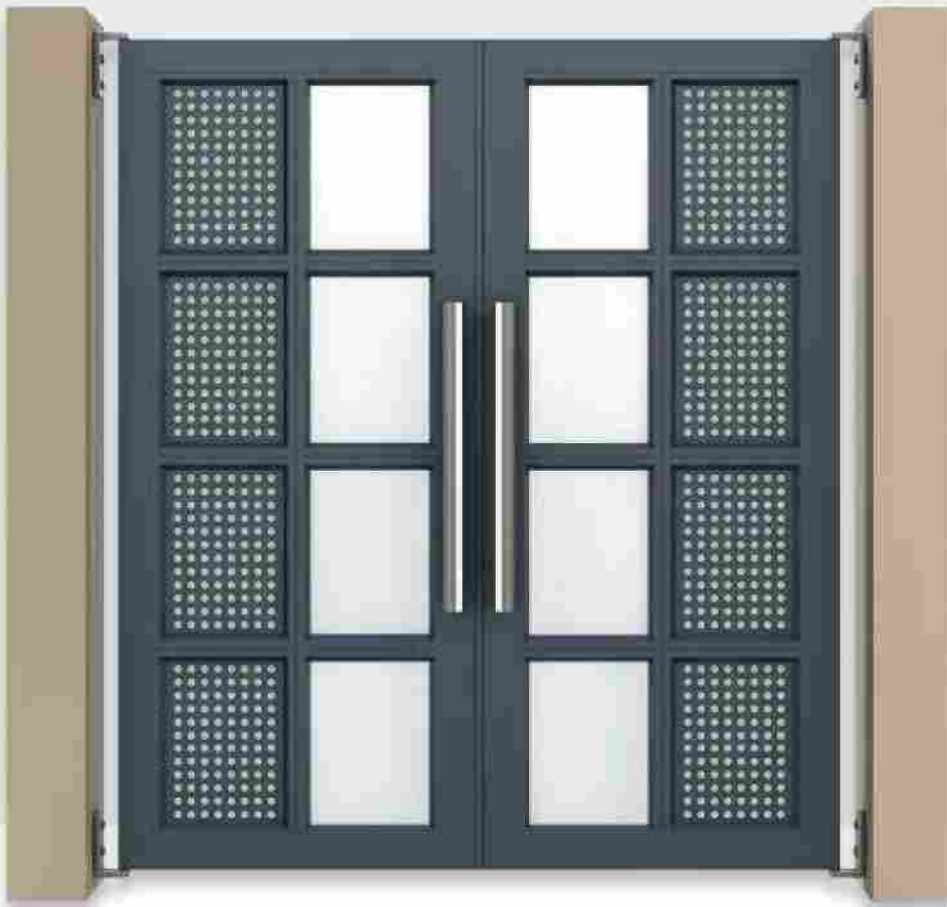

GC02.02



Supporting frame and aluminium profile.  
Châssis de support en profilé d'aluminium.



External stainless hinge that can be regulated  
by  $\pm 2$ mm.  
Charnière extérieure inoxydable de support  
réglable à  $\pm 2$ mm.



GC02.06



GC02.01

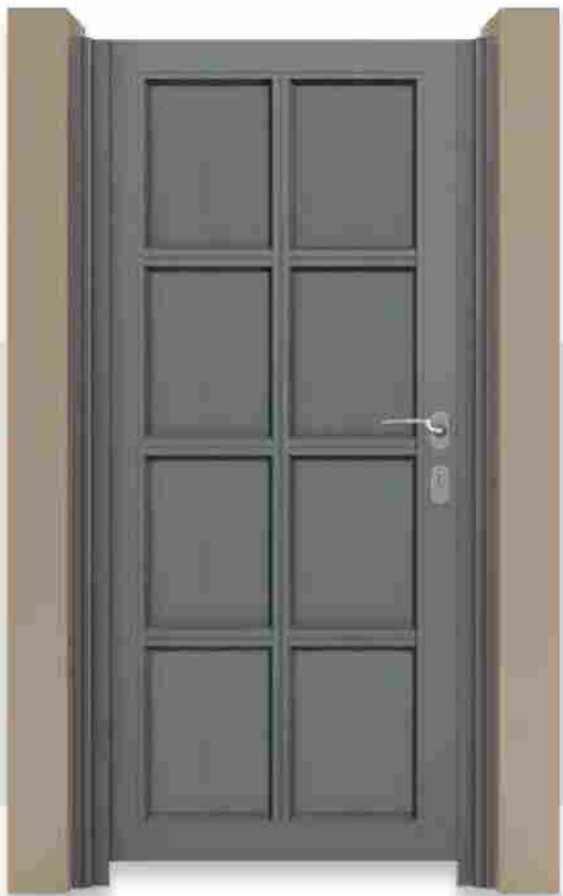

GC01.09



GC01.08



GC02.03



GC12.07

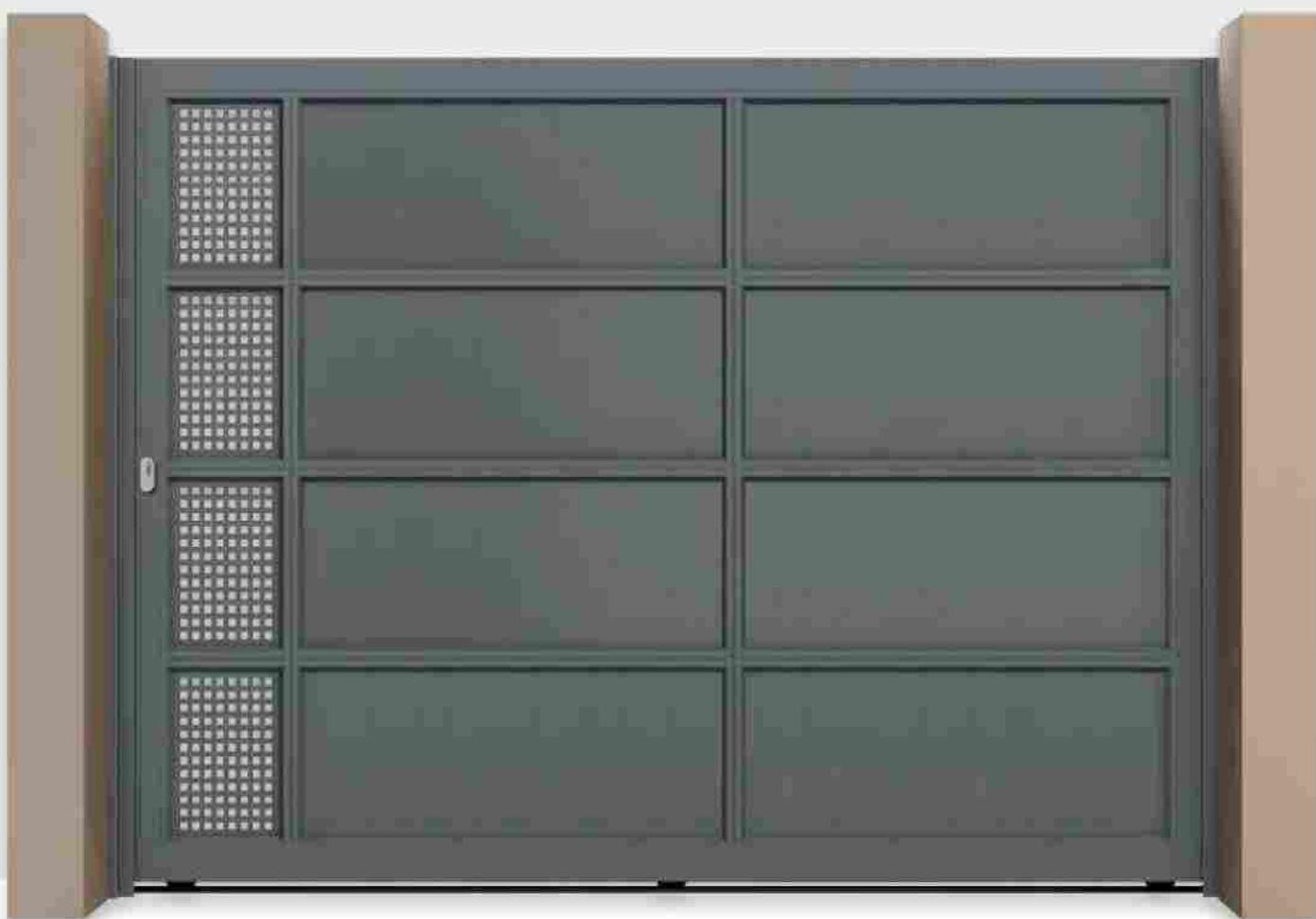

GC05.01



GC05.13 Aluminium frame on colored inox and patterned horizontal rabote in any color.  
Encadrement d'aluminium de couleur inox et raboté strié horizontal disponibles dans toutes les couleurs.





**GC01.10** Aluminium frame on colored inox and patterned vertical rabote in any color.  
Encadrement en aluminium de couleur inox et raboté strié vertical disponible dans toutes les couleurs.



**GC01.11** Aluminium frame in inox and patterned rabote with a 2-8 cm gap.  
Encadrement en aluminium de couleur inox et raboté strié avec un espacement de 2 à 8cm.



**GC01.12**



GD02



GD02.01



GD01.05

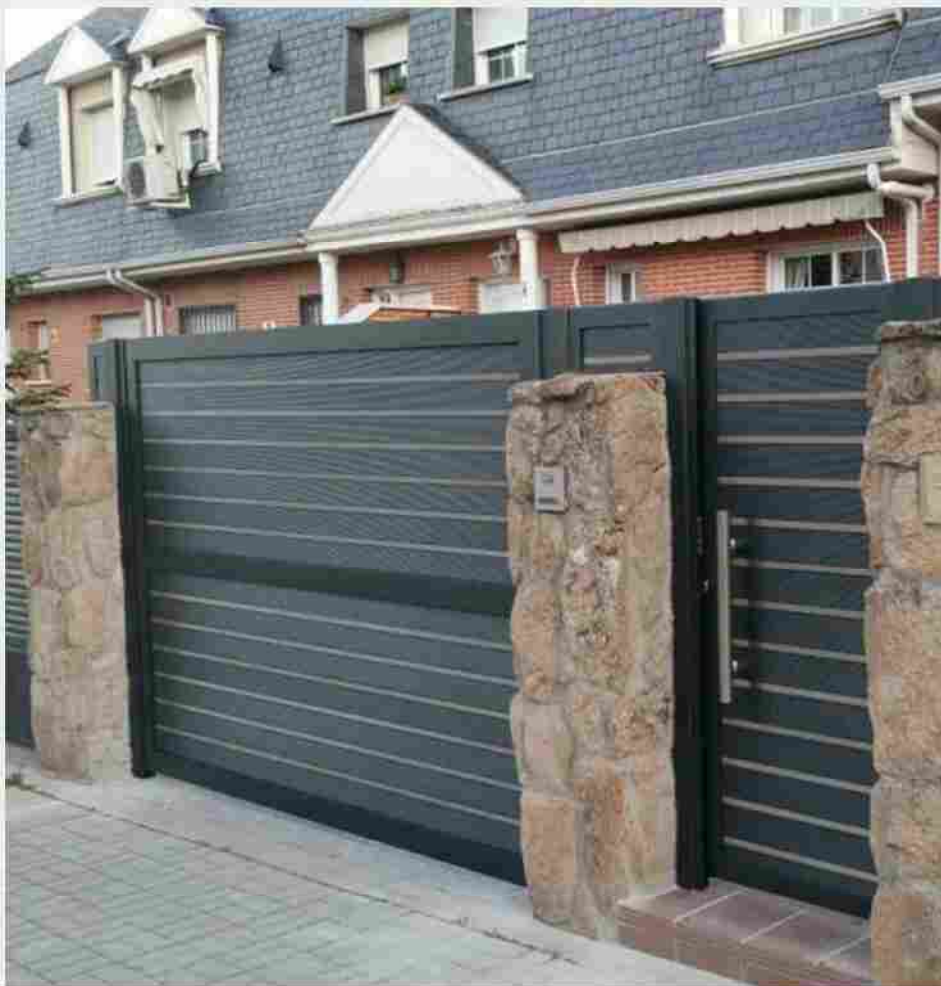

GD01.05



GD01.07

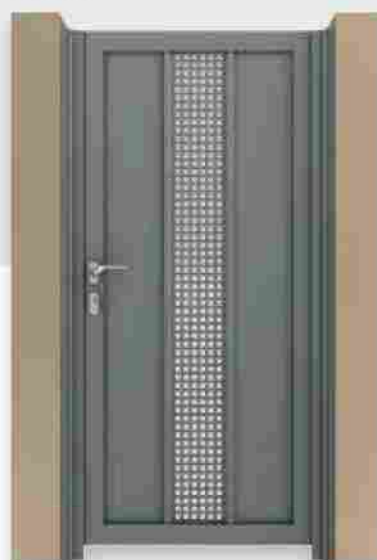

GD01.08



GD01.06



FD10.01 Fence with built transom.  
Clôture avec petit bois.

# Classic

Classic



KP. 021



KP. 001



KP. 022



KP. 018

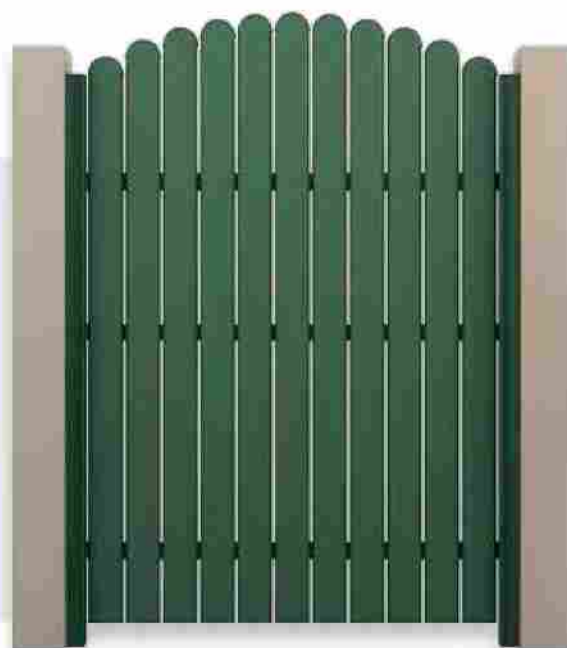

KP. 020

Traditional gates in a great variety of patterns and colors. They are painted with electrostatic dye and have undergone seaside class treatment offering protection from salinity. They are available in a wide range of color shades, special colors and wood imitation shades. They guarantee a long life, high endurance in tough weather conditions and do not need maintenance.

Des portails traditionnels avec une grande gamme de motifs et de coloris. Ils sont enduits de peinture électrostatique et ont subi un traitement spécial seaside class, offrant une protection de la salinité. Ils sont disponibles en de nombreux coloris & couleurs spéciales d'aspect bois. Ils garantissent une longue durée de vie, une forte résistance face aux conditions environnementales et bien sûr ils ne demandent pas d'entretien



KP. 002



KP. 014



KP. 011



KP. 010

# OBRAS REALIZADAS DE VALLAS MODERNAS





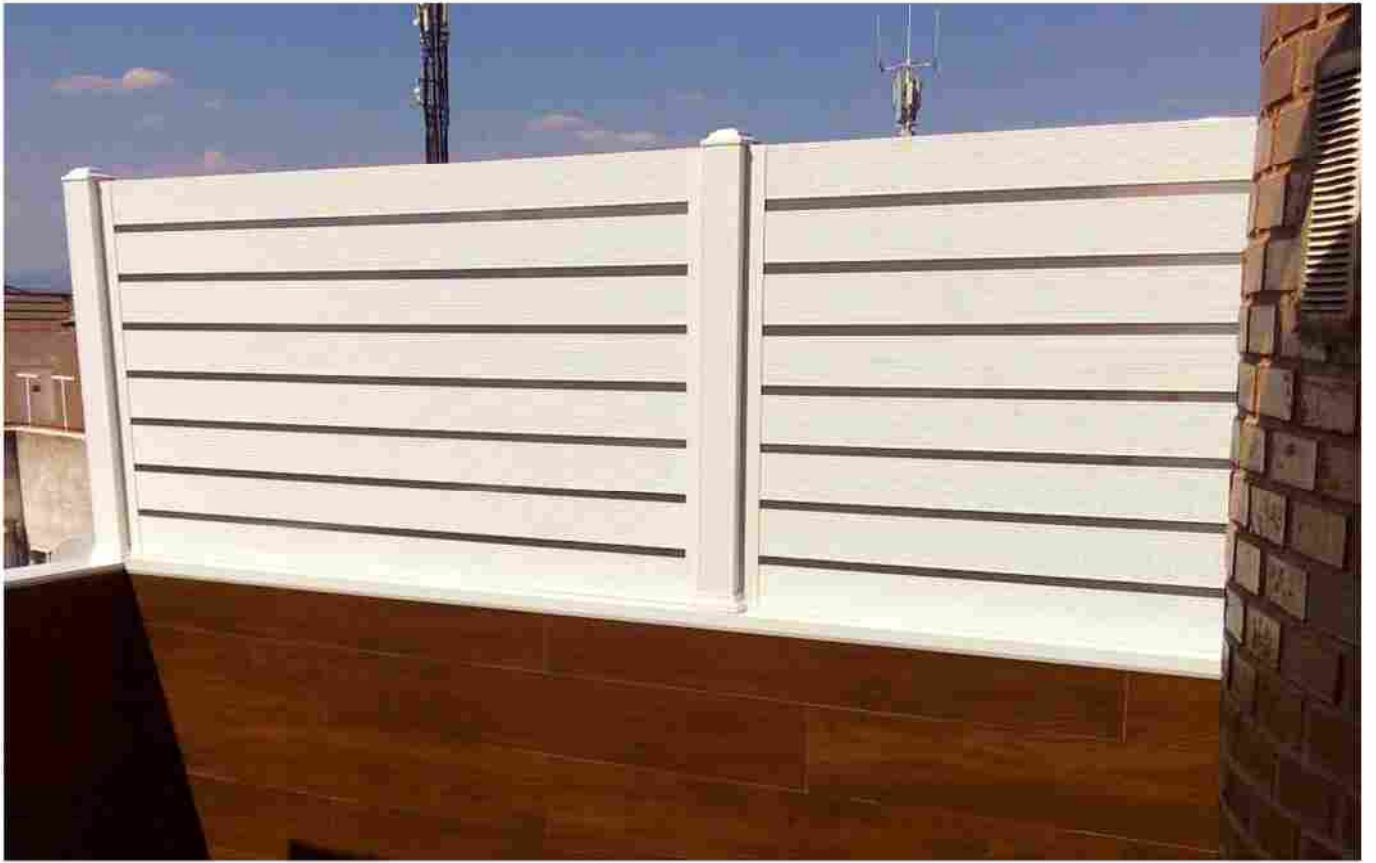





# **OBRAS REALIZADAS DE CANCELAS MODERNAS**





# Accessories

## Accessories | Accessoires



**4197**  
Frame-sash hinge.  
Charnière de châssis  
- vantail.



**4196**  
Inox hinge externally  
regulated (pair).  
Charnière en inox  
extérieure réglable (paire).



**4904**  
Swinging door stop.  
Capuchon d'étanchéité  
de portail ouvrant.



**177-401**  
Sliding door roller Ø70  
attached by screws.  
Roues de portail  
coulissant Ø70 vissé.



**182-400**  
Sliding door roller  
teflon Ø30.  
Roues de portail  
coulissant teflon Ø30.



**4145**  
Sliding door roller support.  
Charnière mural de porte  
coulissante.



**165-400**  
Inox handle (pair).  
Poignée inox (paire).



**165-401L** (left/gauche)  
**165-401R** (right/droite)  
Inox handle (single).  
Poignée inox (unique).



**165-100**  
Sliding gate lock  
cylinder (pair).  
Rosette du cylindre  
de portail coulissant  
(paire).



**181-401**  
Sliding gate hook lock.  
Serrure de crochet de  
portail coulissant.



**EA410-710**  
35mm tilt and turn lock.  
Serrure de portail  
ouvrant de 35mm.



**EA410-723**  
75mm tilt and turn gate  
lock cylinder.  
Cylindre de serrure  
de portail ouvrant de  
75mm.



**EA410-728**  
75mm tilt and turn gate  
security lock cylinder.  
Cylindre de serrure  
de portail de sécurité  
ouvrant de 75mm.



**EA410-724**  
60mm sliding gate  
lock cylinder.  
Cylindre de serrure de  
portail coulissant de  
60mm.



**4118 / 4120**  
Support column  
70-001 / 963 & 965



**4113**  
Support foot for  
column 963 & 965



**297**  
Plastic cover for  
column 070-001



**299**  
Plastic connector for  
070-002



**300**  
Plastic cover for  
070-004



**301**  
Cover for 070-004

# Accessories

## Handles | Poignée



Length	Code
400mm	0871X2-040
500mm	0871X2-050
600mm	0871X2-060
800mm	0871X2-080
1000mm	0871X2-100
1200mm	0871X2-120
1500mm	0871X2-150
1600mm	0871X2-160
1800mm	0871X2-180
2000mm	0871X2-200

Handle mat nickel / chrome.  
Poignée matte nickel / chrome.



Length	Code
400mm	0873X1-040
500mm	0873X1-050
600mm	0873X1-060
800mm	0873X1-080
1000mm	0873X1-100
1200mm	0873X1-120
1500mm	0873X1-150
1600mm	0873X1-160
1800mm	0873X1-180
2000mm	0873X1-200

Handle mat nickel.  
Poignée matte nickel.

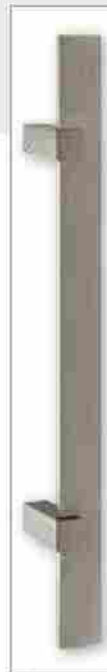

Length	Code
400mm	0879X3-040
500mm	0879X3-050
600mm	0879X3-060
800mm	0879X3-080
1000mm	0879X3-100
1200mm	0879X3-120
1500mm	0879X3-150
1600mm	0879X3-160
1800mm	0879X3-180
2000mm	0879X3-200

Handle nickel / inox.  
Poignée nickel / inox.

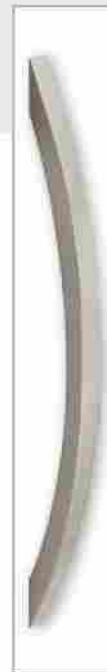

Length	Code
300mm	0883X1-025
555mm	0883X1-050

Handle mat nickel.  
Poignée matte nickel.



Length	Code
400mm	0669X3-040
500mm	0669X3-050
600mm	0669X3-060
800mm	0669X3-080
1000mm	0669X3-100
1200mm	0669X3-120
1500mm	0669X3-150
1600mm	0669X3-160
1800mm	0669X3-180
2000mm	0669X3-200

Handle nickel / inox.  
Poignée nickel / inox.



Length	Code
455mm	0461X3-040
657mm	0461X3-060
858mm	0461X3-080
1059mm	0461X3-100

Handle nickel / inox.  
Poignée nickel / inox.



Length	Code
890mm	0617X3-089

Handle nickel / inox.  
Poignée nickel / inox.



Length	Code
600mm	165-500

Handle  $\Phi$ 40 anodised aluminum.  
Poignée de  $\Phi$ 40 d'aluminium avec anodisation.

# Types

## Typical constructions

## Tipos de construcciones

ALUMINCO gates are constructed using accessories made of aluminium and stainless steel offering maximum protection against corrosion. They come in many patterns and combinations whilst the same pattern may be used in a single sash gate, a single sash gate with fixed, double sash gate and sliding gate.

Les portails d'ALUMINCO sont fabriqués avec des accessoires en aluminium et en acier inoxydable pour offrir la plus grande protection possible contre la corrosion. Ils sont disponibles en plusieurs modèles et combinaisons tandis que le motif lui-même peut être créé sur des portails à un vantail, à un vantail avec une partie fixe, à deux vantaux et coulissant.

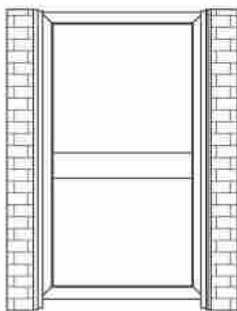

Single sash swing gate  
A un vantail ouvrant

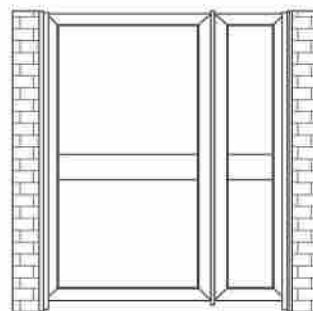

Single sash swing with fixed  
A un vantail avec une partie fixe

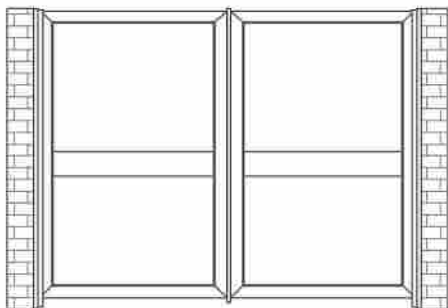

Double sash swing gate  
A deux vantaux ouvrant

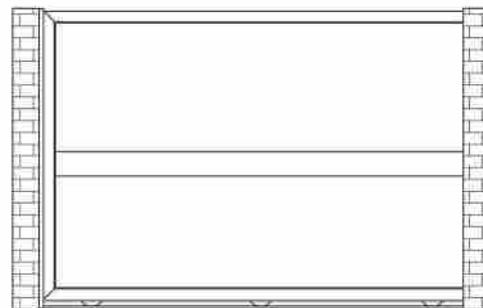

Sliding gate  
Coulissant

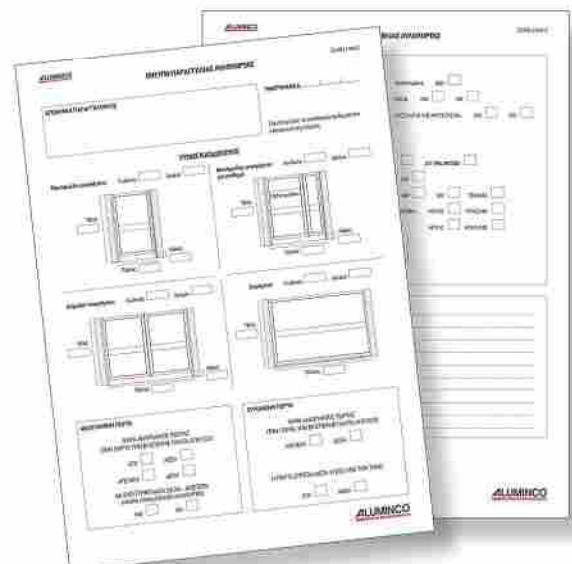

# Sections Blind V

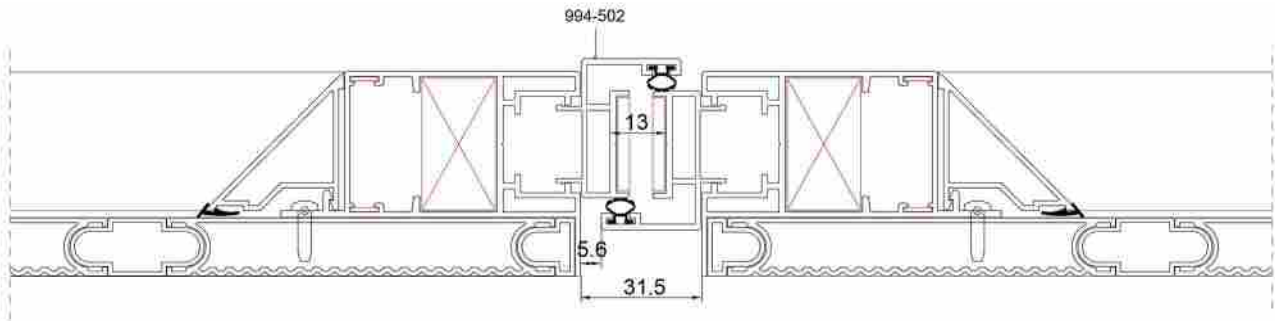
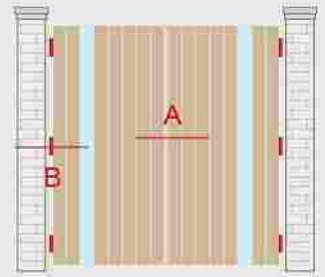

Section A  
Scale 3:4

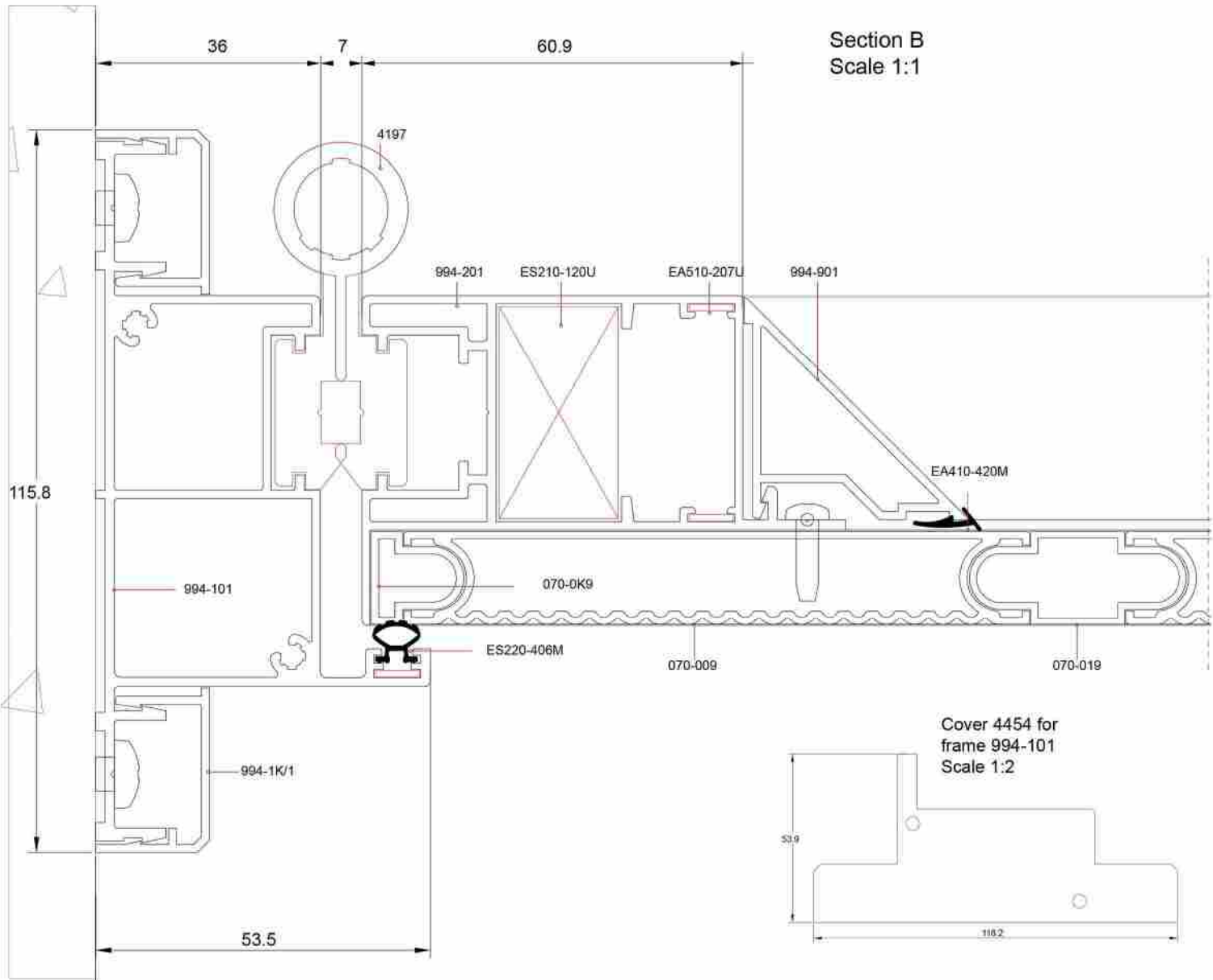

Section B  
Scale 1:1

Cover 4454 for  
frame 994-101  
Scale 1:2

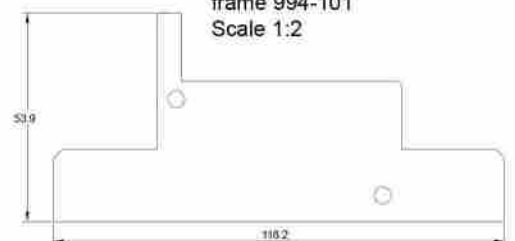

# Sections Blind V

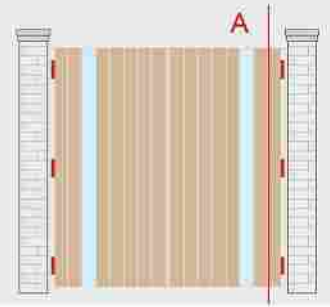

Section A  
Scale 1:2

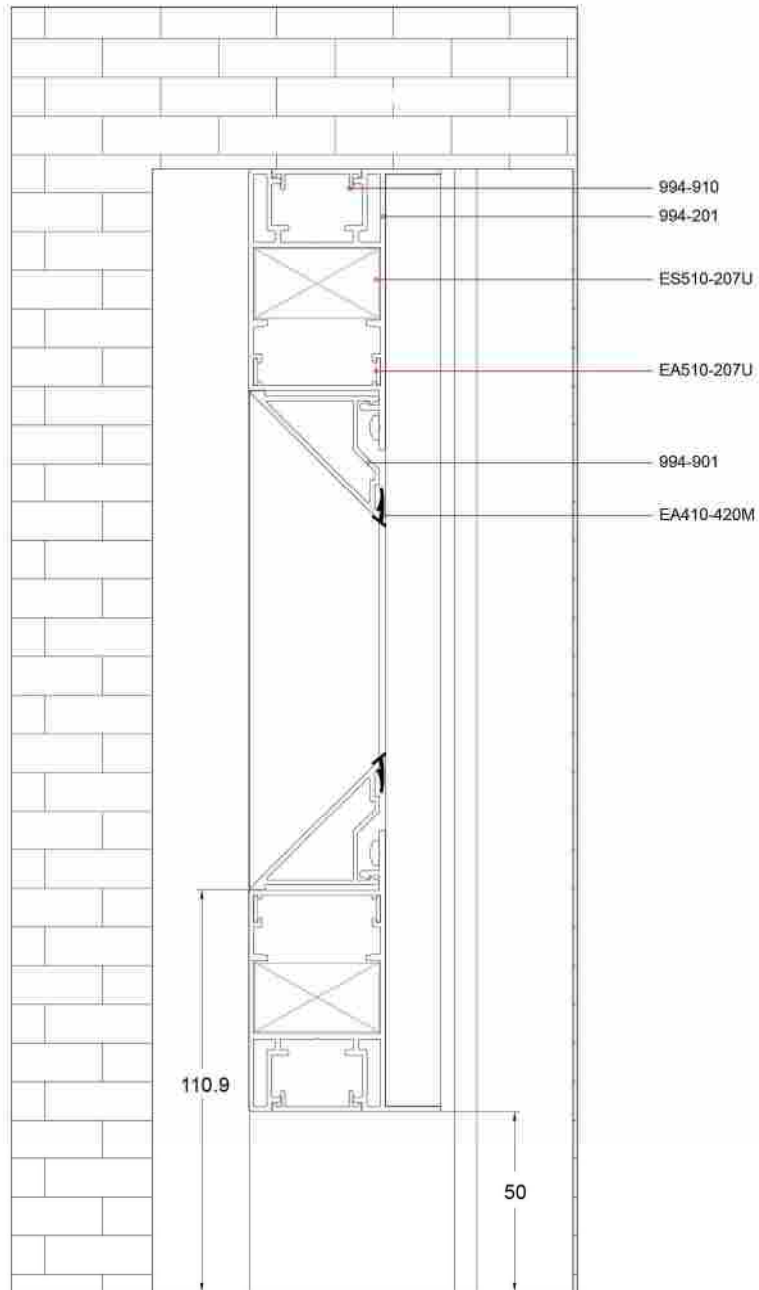



# Sections Blind V

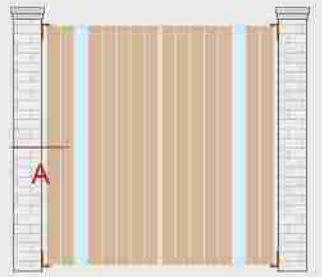

Section A  
Scale 1:1

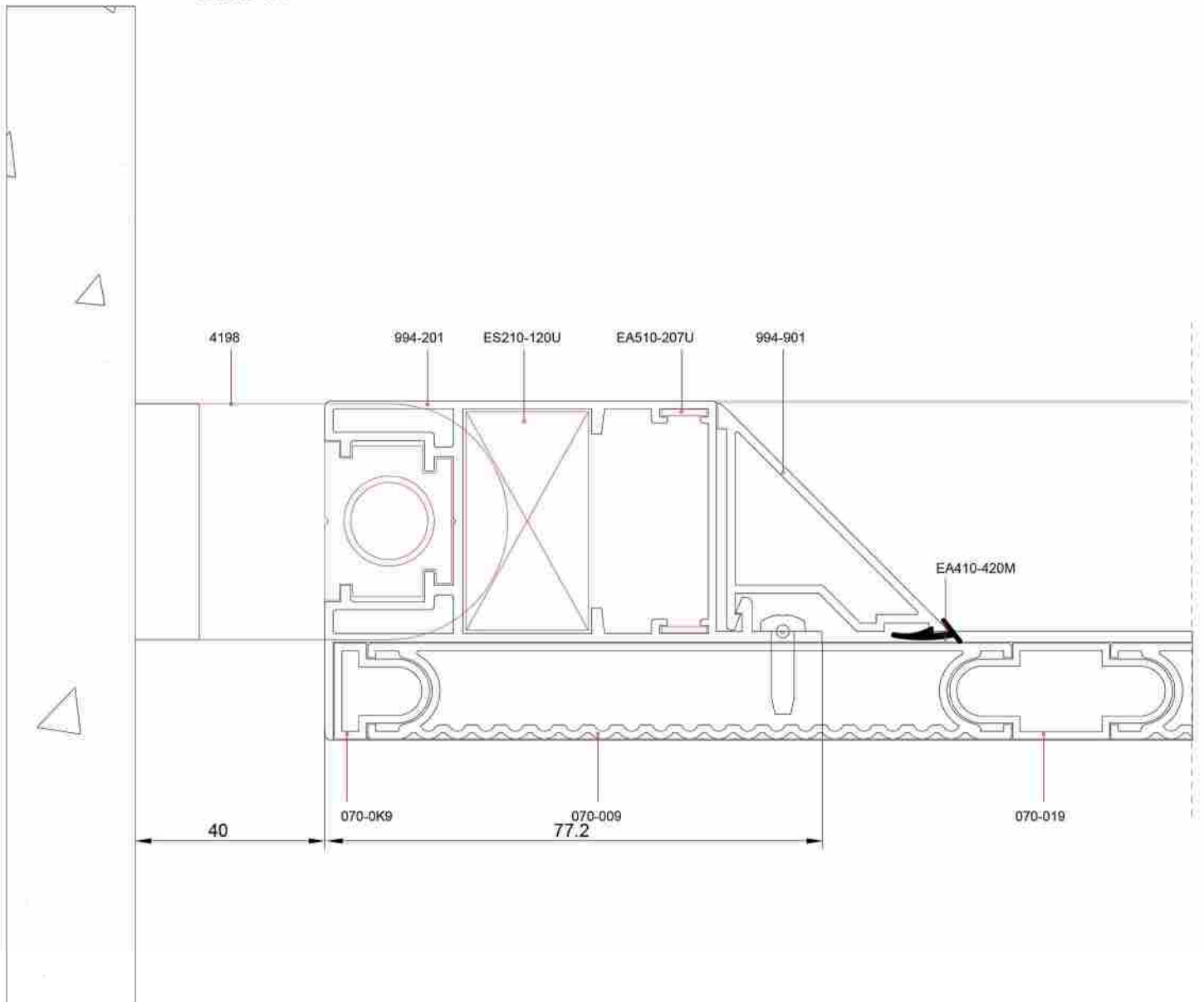

# Sections Blind V

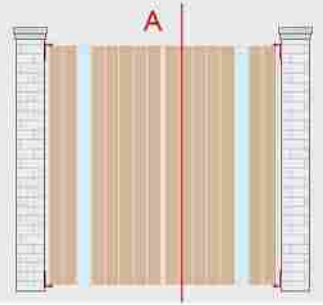

Section A  
Scale 1:2

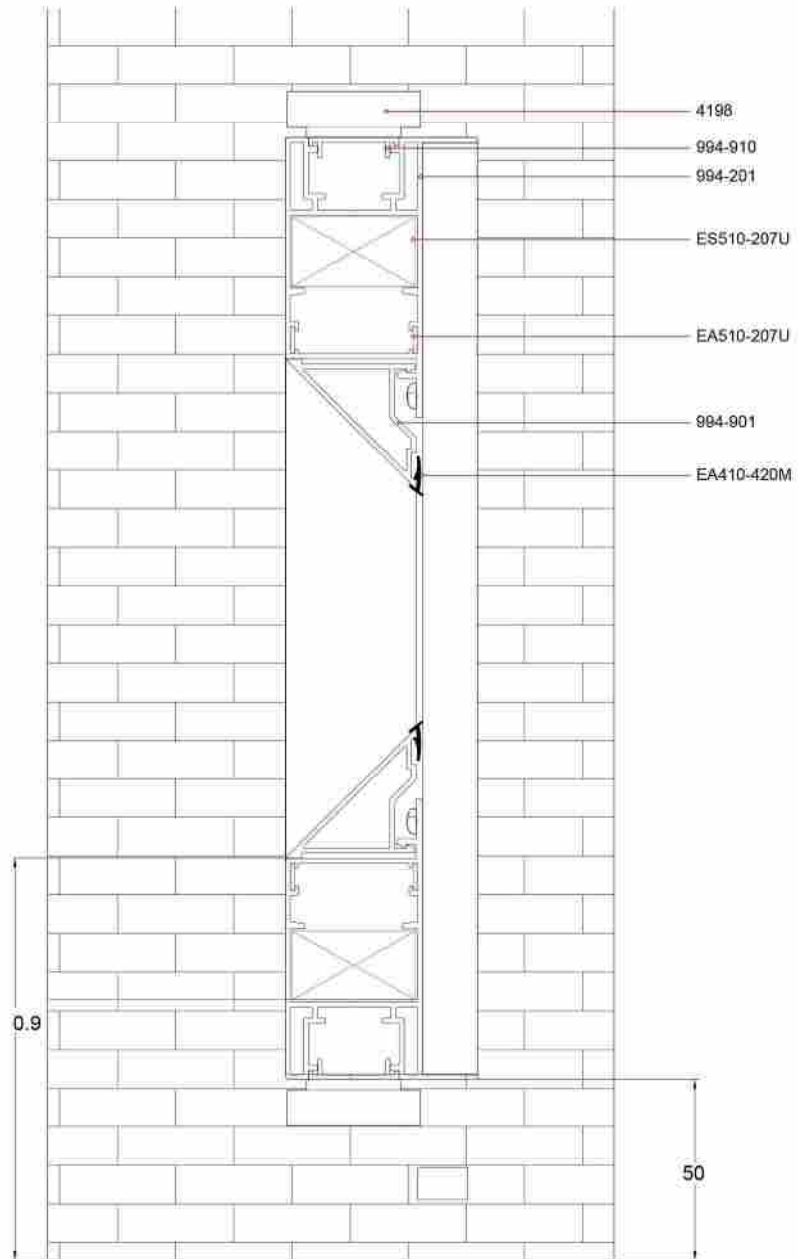

# Sections Blind H

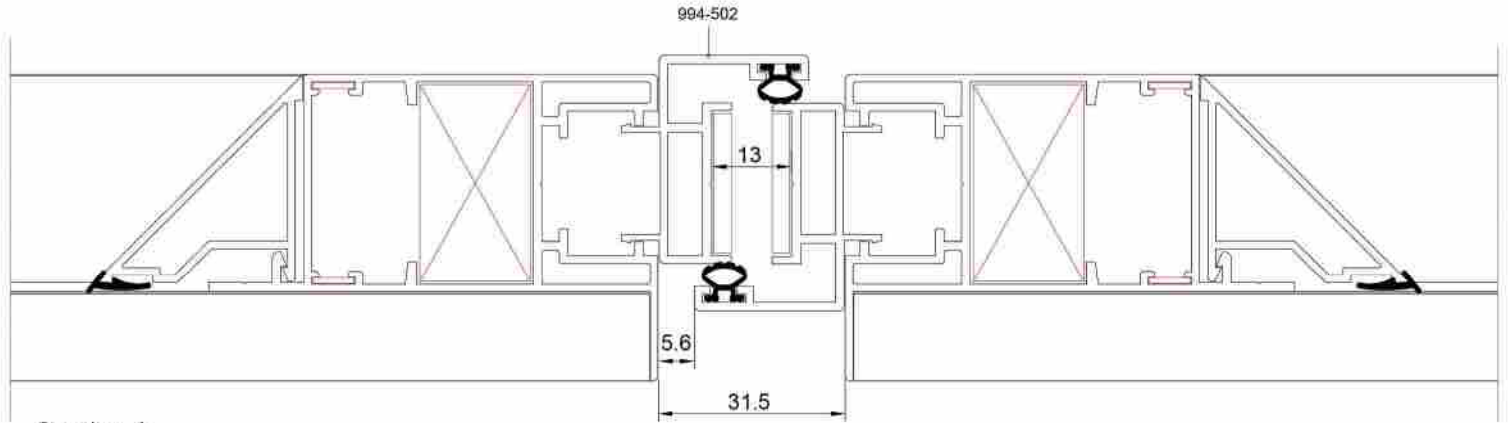
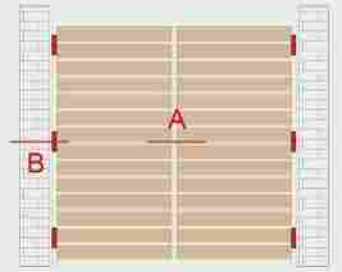

Section A  
Scale 1:1

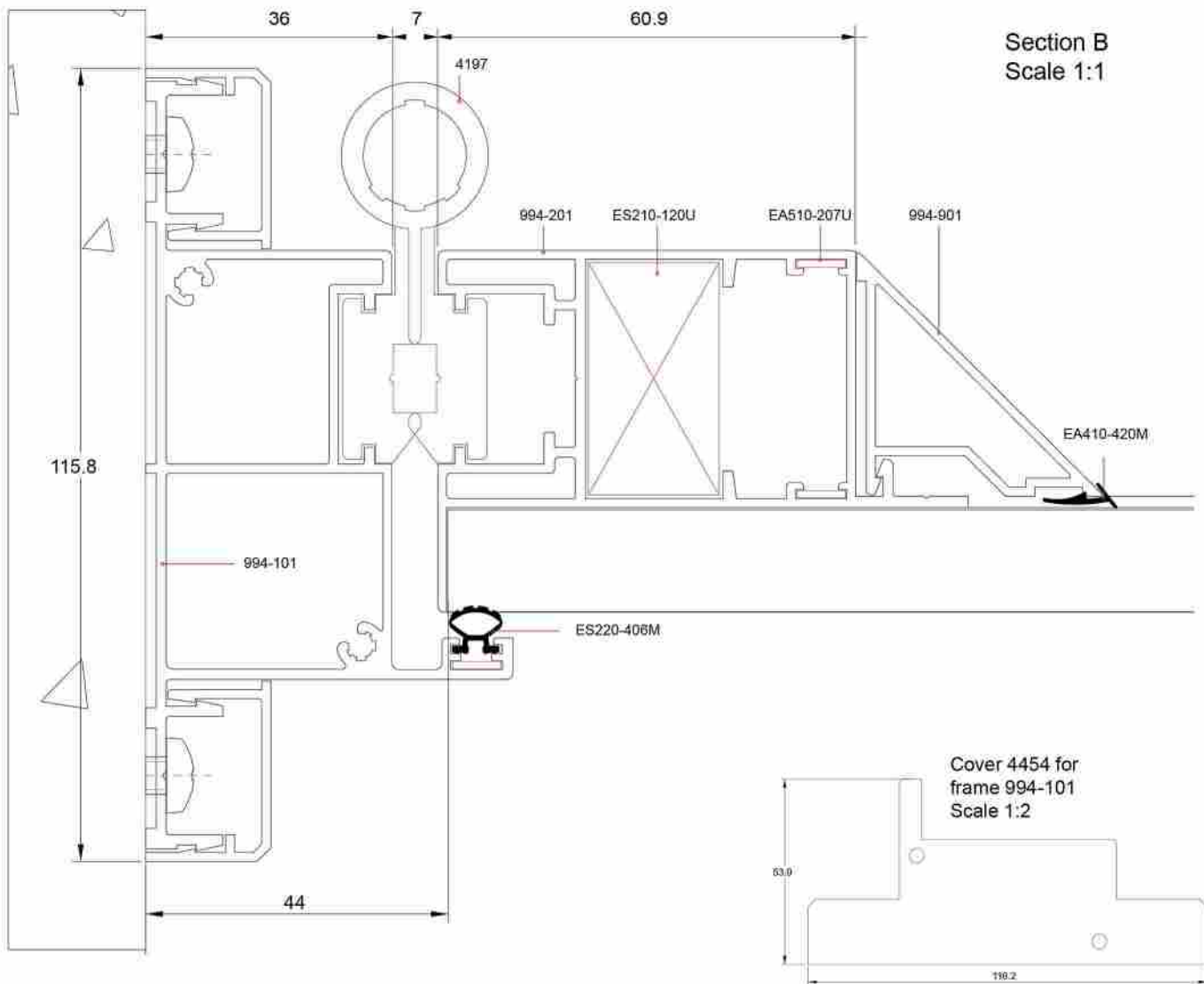

Section B  
Scale 1:1

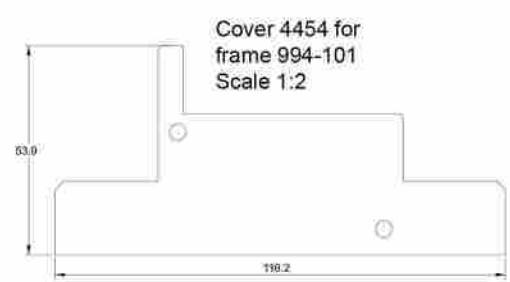

# Sections Blind H

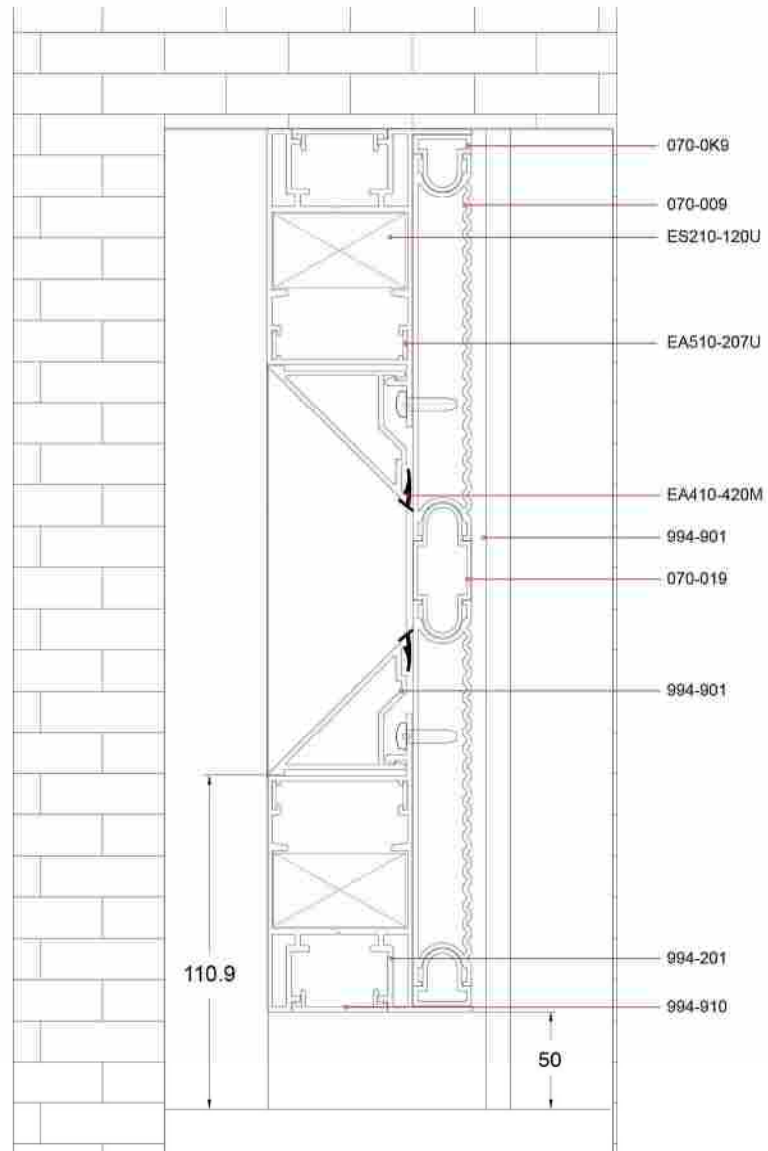
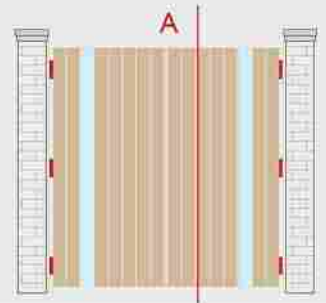

# Fence

## Vallas Vertical constructions

### Construcciones en Vertical

The wide range of aluminium profiles offers many constructions possibilities for fences in vertical and horizontal arrangement. Choose among the 8 different fence designs and combine them with the respective gates.

Los diferentes tipos de perfiles de aluminio, ofrece la posibilidad para montarlo de forma vertical y horizontal. Ofrece entre 8 diferentes diseños y combinaciones entre ellos:

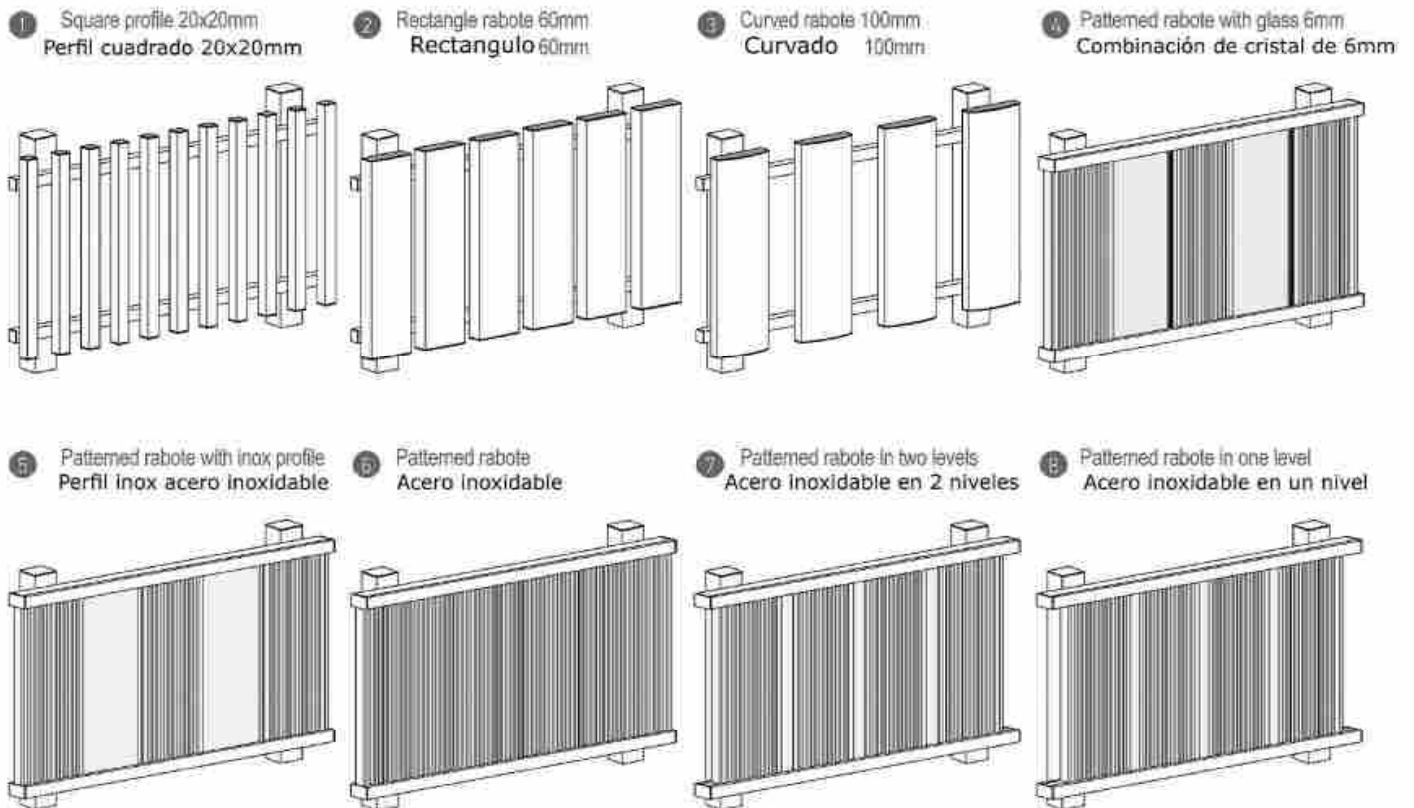

	Column / Columna	Connection - Transom / Perfil travesaño	Vertical profiles / Perfil vertical
1	998-104 / 994-910	823	029-008
2	998-104 / 994-910	823	059-010
3	998-104 / 994-910	823	070-002
4	F50-106	F50-310 / F50-3K10 / F50-311	070-009 / 070-0K9
5	F50-106	F50-310 / F50-3K10 / F50-311	070-009 / 994-907 / 070-0K9
6	F50-106	F50-310 / F50-3K10 / F50-311	070-011 / 070-0K9 / 070-K11
7	F50-106	F50-310 / F50-3K10 / F50-311	070-009 / 510-918 / 070-0K9
8	F50-106	F50-310 / F50-3K10 / F50-311	070-009 / 070-019 / 070-0K9

Distance between vertical profiles, for types 1, 2, 3: 4 to 11cm  
Distancia entre perfiles verticales 1, 2, 3: 4 a 11cm

# Fence

## Vallas Horizontal constructions

### Construcciones en Horizontal

Create your own fence choosing among the 14 different aluminium designs combining materials such as straight and oval aluminium, triplex glass 6mm, perforated aluminium sheet.

Para la construcción de Vallas, existen la posibilidad de 14 diseños diferentes pudiéndolos combinar entre ellos con perfiles de aluminio en Inox, además pudiendo incluir cristal de 6 mm como otra alternativa a la construcción horizontal.

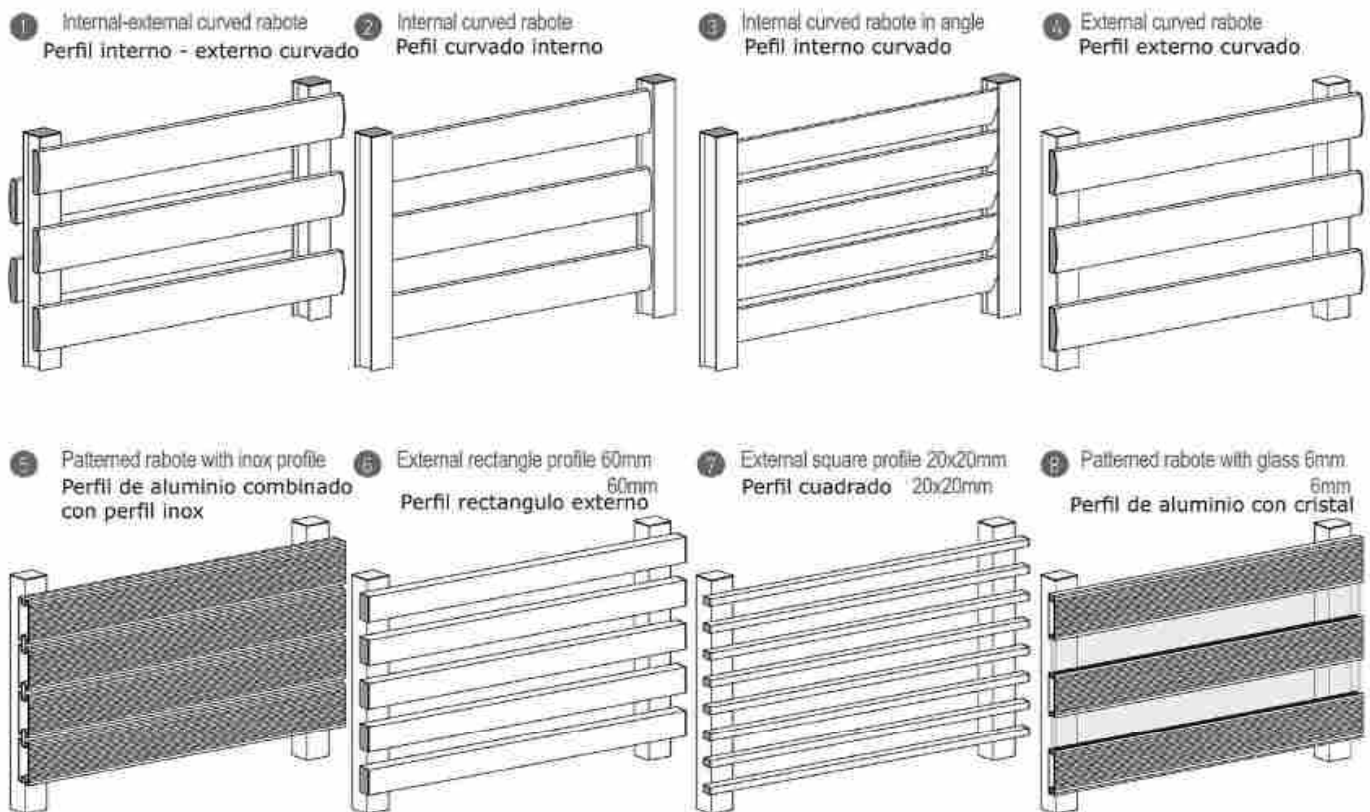

	Column / Columna	Horizontal profiles / Perfil horizontal
1	070-001	070-002
2	070-001	070-002
3	070-001	070-002
4	998-104 / 994-910	070-002
5	998-104 / 994-910	070-004 / 510-918 / 070-0K4
6	998-104 / 994-910	059-010
7	998-104 / 994-910	029-008
8	998-104 / 994-910	070-009 / 070-0K9

Corner construction for types:  
Tipos de construcciones:

4 8 9 10 11 12



Corner construction for type:  
Tipos de construcciones:

13

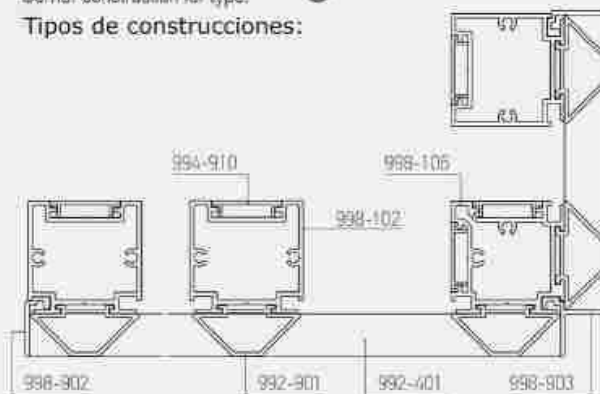

9 Patterned rabote with inox profile  
Perfil de aluminio  
combinada con inox

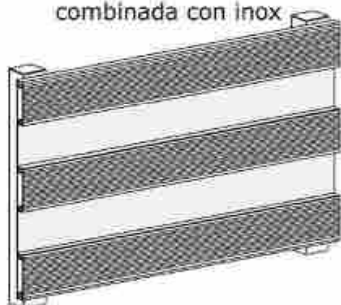

10 Patterned rabote  
Perfil solo con aluminio

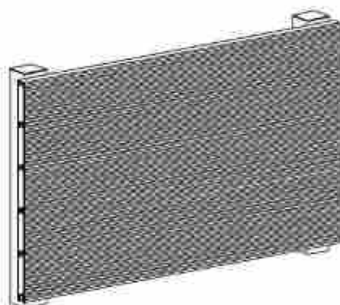

11 Patterned rabote in two levels  
Perfiles en 2 niveles

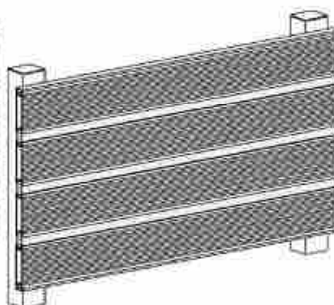

12 Patterned rabote in one level  
Perfiles en un nivel

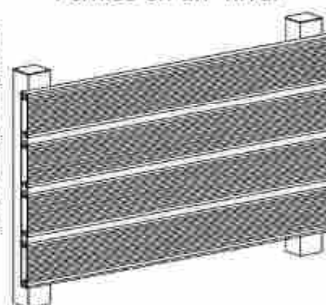

15 Fence with transom  
Perfiles con travesaños

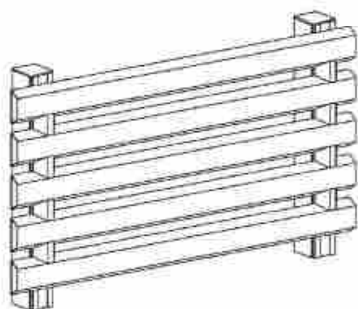

	Column / Columnas	Horizontal profiles / Perfil horizontal
9	998-104 / 994-910	070-009 / 994-907 / 070-0K9
10	998-104 / 994-910	070-011 / 070-K11 / 070-0K9
11	998-104 / 994-910	070-009 / 510-918 / 070-0K9
12	998-104 / 994-910	070-009 / 070-019 / 070-0K9
13	998-102 / 994-910 / 992-901	992-401

### Frames

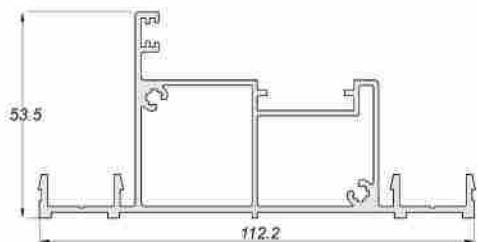

**994-101**  
1523 gr/m

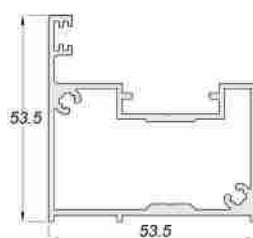

**994-102**  
1045 gr/m

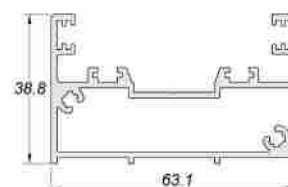

**994-105**  
1126 gr/m

### Sashes

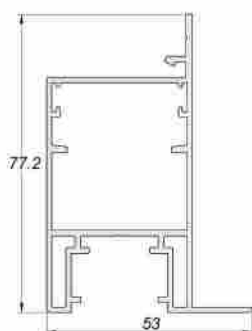

**994-201**  
1137 gr/m

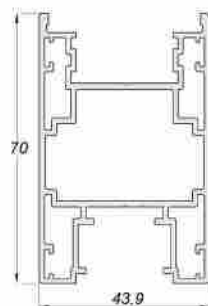

**994-202**  
1439 gr/m



**994-205**  
1869 gr/m

### Adapter

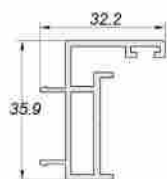

**994-502**  
490 gr/m



## Transoms :Travesaños

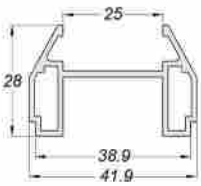

**992-903**  
533 gr/m

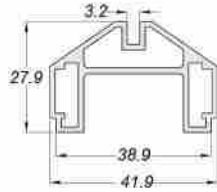

**992-904**  
650 gr/m

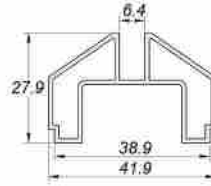

**994-914**  
489 gr/m

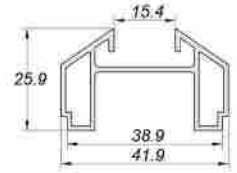

**994-115**  
475 gr/m

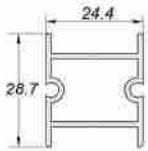

**992-913**  
384 gr/m

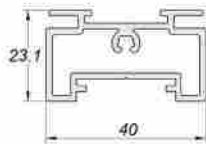

**994-601**  
670 gr/m

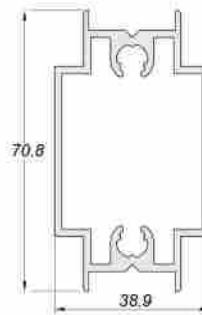

**994-405**  
1269 gr/m

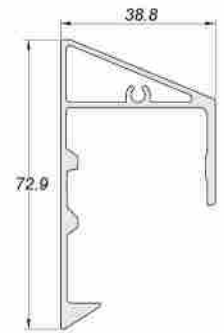

**994-905**  
885 gr/m

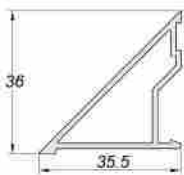

**994-901**  
419 gr/m

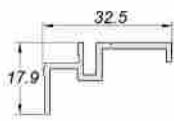

**944-902**  
243 gr/m

# Fence

**Fence** :Vallas

System profiles | Sistema de perfiles

## Columns & caps | Columnas y Tapas

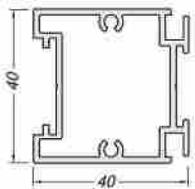

**998-102**  
821gr/m

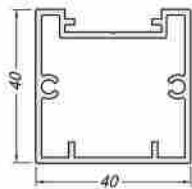

**998-104**  
783gr/m

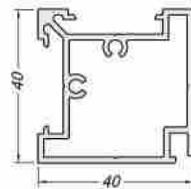

**998-105**  
840gr/m

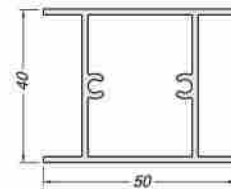

**070-001**  
772gr/m

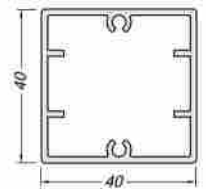

**F50-106**  
794gr/m

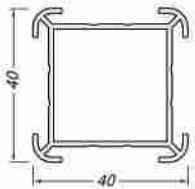

**915**  
621gr/m

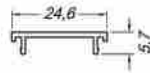

**994-910**  
116gr/m

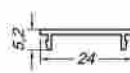

**971-200**  
108gr/m

## End & corner profiles | Perfiles para esquina & final de rail

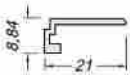

**998-902**  
127gr/m

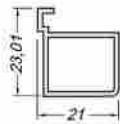

**998-901**  
168gr/m

## Transoms | Perfiles,tapas y rail para pasamanos

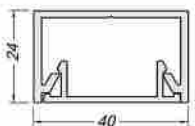

**823**  
518gr/m

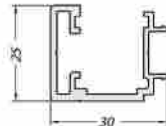

**F50-310**  
427gr/m

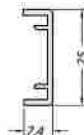

**F50-3K10**  
157gr/m

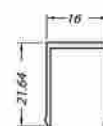

**F50-311**  
176gr/m

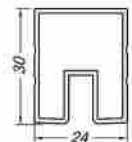

**095**  
408gr/m

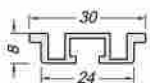

**981**  
250gr/m

Profiles, caps & inox elements | Perfiles, tapas & Elementos en inox

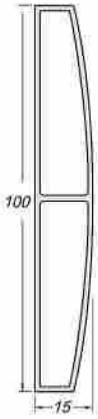

**070-002**  
789gr/m

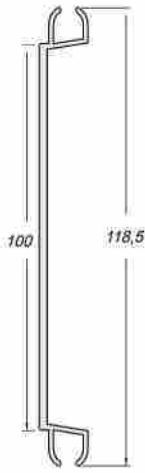

**994-907**  
729gr/m

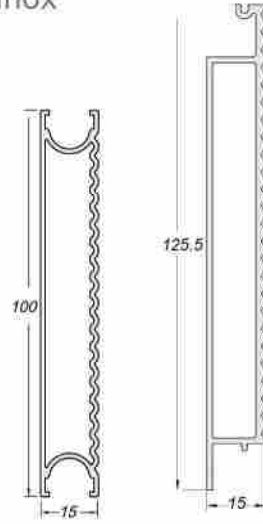

**070-009**  
818gr/m

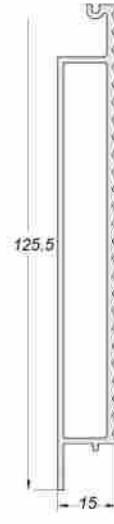

**070-010**  
1166 gr/m

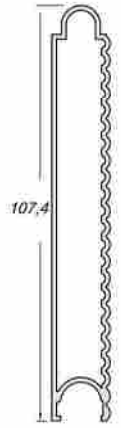

**070-011**  
837gr/m

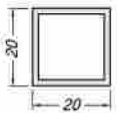

**029-008**  
300gr/m



**059-010**  
624gr/m



**992-401**  
536gr/m

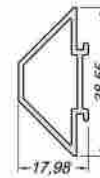

**992-901**  
329gr/m



**070-K11**  
143gr/m



**510-918**  
283gr/m



**070-019**  
259gr/m



**070-0K9**  
133gr/m



**980**  
206gr/m

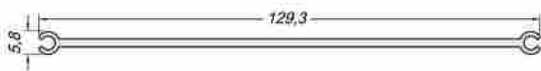

**979-200**  
715gr/m



**ALUMINCO & PANEL, S.L**  
**C/ARROYO DEL CULEBRO, S/N**  
**POL.IND.LAS ARENAS DE PINTO**  
**PINTO-MADRID.C.P:28320.ESPAÑA**  
**TLF:91.692.68.50.**



**WWW.ALUMINCO.ES**

**EMAIL:info@aluminco-panel.es**